

Title: **PIPING CLASS Edmeston SX®**

Approved by:

Subject: **CONCENTRIC REDUCERS**

AHD

**Material:**

Edmeston SX® Alloy. Approvals according to TÜV Einzelgutachten (latest edition) and UNS S32615.

**Certificates:**

According to EN 10204-3.1(raw material) and NDT-reports.

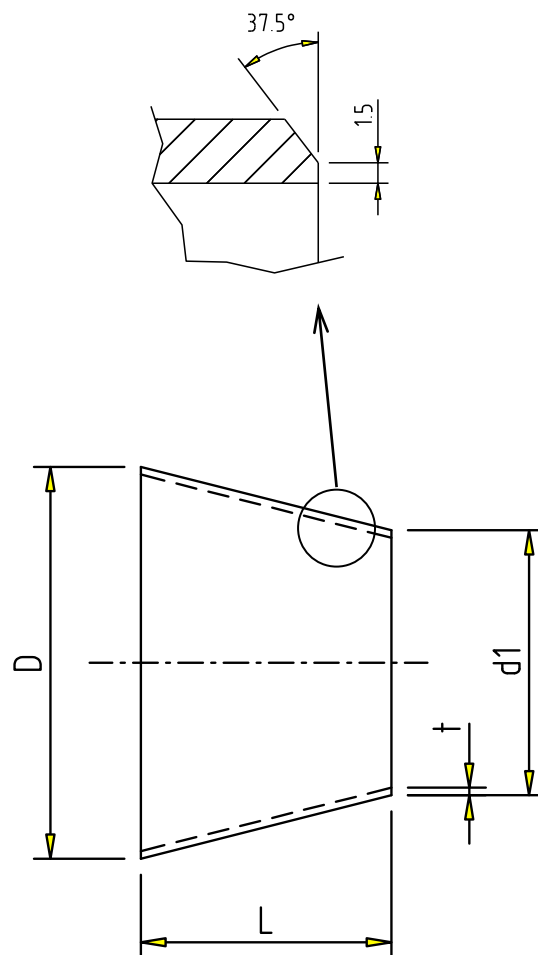

Title: **PIPING CLASS Edmeston SX®**  
 Subject: **CONCENTRIC REDUCERS**

Approved by:  
 AHD

DN	D (mm)	d <sub>1</sub> (mm)	t (mm)	L (mm)	Weight (kg)
50 x 25	60.3	33.2	3	76	0.3
65 x 50	76.1	60.3	3	89	0.4
80 x 25	88.9	33.2	3	89	0.4
80 x 50	88.9	60.3	3	89	0.6
100 x 50	114.3	60.3	4	102	0.8
100 x 80	114.3	88.9	4	102	1.0
125 x 80	139.7	88.9	4	127	1.4
125 x 100	139.7	114.3	4	127	1.6
150 x 80	168.3	88.9	4	140	1.7
150 x 100	168.3	114.3	4	140	1.9
150 x 125	168.3	139.7	4	140	2.1
200 x 100	219.1	114.3	4	152	2.5
200 x 125	219.1	139.7	4	152	2.6
200 x 150	219.1	168.3	4	152	2.9
250 x 125	273.1	139.7	4	178	3,6
250 x 150	273.1	168.3	4	178	3,8
250 x 200	273.1	219.1	4	178	4,3
300 x 150	323.9	168.3	4	203	4,9
300 x 200	323.9	219.1	4	203	5,4
300 x 250	323.9	273.1	4	203	5,9
350 x 200	355.6	219.1	4	330	9,3
350 x 250	355.6	273.1	4	330	10,2
350 x 300	355.6	323.9	4	330	11,0
400 x 200	406.4	219.1	6	356	13.0
400 x 250	406.4	273.1	6	356	17.7
400 x 300	406.4	323.9	6	356	19.0
400 x 350	406.4	355.6	6	356	19.9
450 x 250	457.2	273.1	6	381	20.5
450 x 300	457.2	323.9	6	381	21.8
450 x 350	457.2	355.6	6	381	22.7
450 x 400	457.2	406.4	6	381	24.2
500 x 350	508.0	355.6	6	508	32.2
500 x 400	508.0	406.4	6	508	34.1
500 x 450	508.0	457.2	6	508	36.1
550 x 500	559.0	508.0	6	508	37.0
600 x 400	609.6	406.4	6	508	38,1
600 x 450	609.6	457.2	6	508	39,9
600 x 500	609.6	508.0	6	508	41,8