

Title: **PIPING CLASS Edmeston SX®**

Approved by:

Subject: **ECCENTRIC REDUCERS**

AHD

**Material:**

Edmeston SX® Alloy. Approvals according to TÜV Einzelgutachten (latest edition) and UNS S32615.

**Certificates:**

According to EN 10204-3.1 (raw material) and NDT-reports.

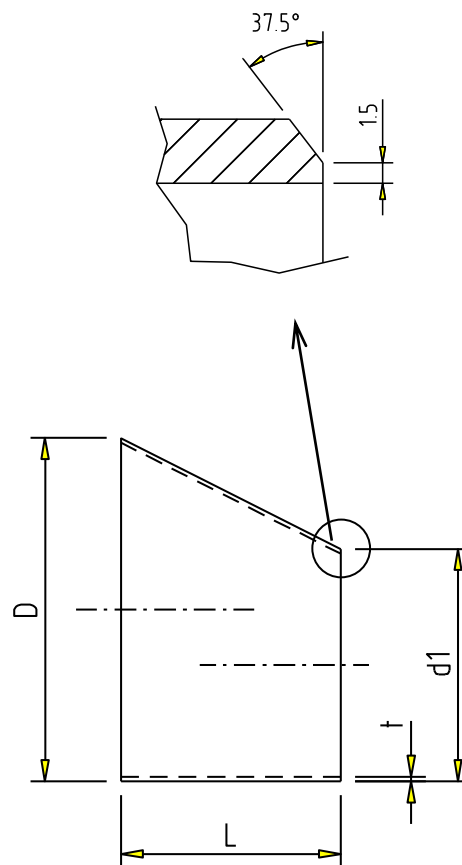

Title: **PIPING CLASS Edmeston SX®**

Approved by:

Subject: **ECCENTRIC REDUCERS**

AHD

<b>DN</b>	<b>D (mm)</b>	<b>d<sub>1</sub> (mm)</b>	<b>t (mm)</b>	<b>L (mm)</b>	<b>Weight (kg)</b>	<b>Remarks</b>
50 x 25	60.3	33.2	3	76	0.3	
80 x 50	88.9	60.3	3	89	0.6	
100 x 50	114.3	60.3	4	102	0.8	
100 x 80	114.3	88.9	4	102	1.0	
125 x 80	139.7	88.9	4	127	1.4	
125 x 100	139.7	114.3	4	127	1.6	
150 x 80	168.3	88.9	4	140	1.7	
150 x 100	168.3	114.3	4	140	1.9	
150 x 125	168.3	139.7	4	140	2.1	
200 x 100	219.1	114.3	4	152	2.5	
200 x 125	219.1	139.7	4	152	2.6	
200 x 150	219.1	168.3	4	152	2.9	
250 x 125	273.1	139.7	4	178	3.6	
250 x 150	273.1	168.3	4	178	3.8	
250 x 200	273.1	219.1	4	178	4.3	
300 x 150	323.9	168.3	4	203	4.9	
300 x 200	323.9	219.1	4	203	5.4	
300 x 250	323.9	273.1	4	203	5.9	
350 x 200	355.6	219.1	4	330	9.3	
350 x 250	355.6	273.1	4	330	10.2	
350 x 300	355.6	323.9	4	330	11.0	
400 x 250	406.4	273.1	6	356	17.7	
400 x 300	406.4	323.9	6	356	19.0	
400 x 350	406.4	355.6	6	356	19.9	
450 x 300	457.2	323.9	6	381	21.8	
450 x 350	457.2	355.6	6	381	22.7	
450 x 400	457.2	406.4	6	381	24.2	
500 x 350	508.0	355.6	6	508	32.2	
500 x 400	508.0	406.4	6	508	34.1	
500 x 450	508.0	457.2	6	508	36.1	
600 x 400	609.6	406.4	6	508	38.0	
600 x 450	609.6	457.2	6	508	39.9	
600 x 500	609.6	508.0	6	508	41.8	